

FAG

20210-TVP

Barrel roller bearing

Schaeffler ID:
0167018010000Barrel roller bearings 202, main
dimensions to DIN 635-1

Technical information

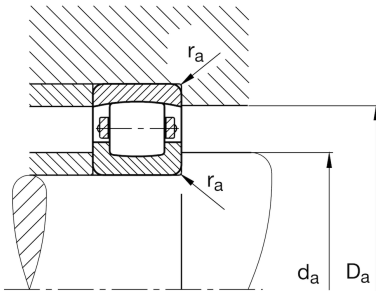
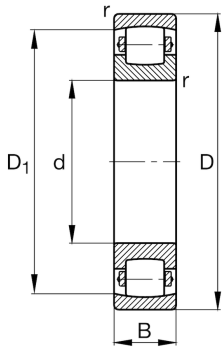
**Main Dimensions & Performance Data**

d	50 mm	Bore diameter
D	90 mm	Outside diameter
B	20 mm	Width
C_r	59,000 N	Basic dynamic load rating, radial
C_{0r}	69,000 N	Basic static load rating, radial
C_{ur}	7,200 N	Fatigue load limit, radial
n_G	7,700 1/min	Limiting speed
	0.481 kg	Weight

Dimensions

r_{min}	1.1 mm	Minimum chamfer dimension
D_1	79.5 mm	Bore diameter outer ring

Mounting dimensions

$d_{a min}$	57 mm	Minimum diameter shaft shoulder
$D_{a max}$	83 mm	Maximum diameter of housing shoulder
$r_{a max}$	1 mm	Maximum recess radius

Temperature range

T_{min}	-30 °C	Operating temperature min.
T_{max}	120 °C	Operating temperature max.